

## Syringe Parts

#0084	Barb, 8-32 & Washer	(Pkg. 10)
#2202	O-Ring	(Pkg. 12)
#2203	O-Ring	(Pkg. 12)
#2211	O-Ring	(Pkg. 12)
#2212	O-Ring	(Pkg. 12)
#2255	O-Ring	(Pkg. 12)
#3060	Syringe Tip	(1 ea.)
#3061	Syringe Tip	(Pkg. 5)
#3059	Syringe Tip	(Pkg. 50)
#3085	Button Valve Assembly	
#9648	Pin, Quick-Clean Syringe Button	
#9670	Spring, Syringe Button	
#9677	Spring, Tip Adapter	

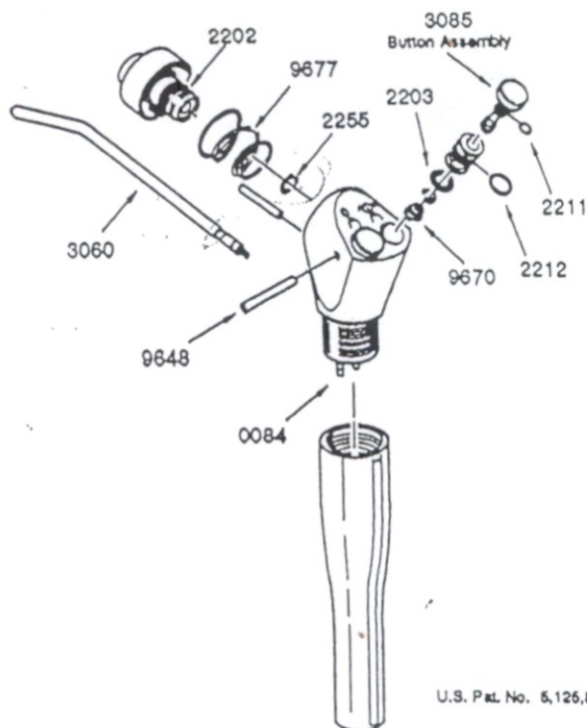

U.S. Pat. No. 5,126,805

## INSTALLATION

Turn off air and water supplies. Determine which of the syringe tubes leads to the air button, and connect that tube to the air outlet on the dental unit or syringe manifold. Connect the other tube to the water outlet. For circulating syringes, the third tube is the return water, and is routed to the drain. Recommended operating pressures: Air 80 psi, Water 40 psi.

## TIP STERILIZATION

To remove the syringe tip, press down on the large collar. When you feel a soft "click," the tip may be pulled straight out. Hold the collar down and insert the new tip. Be sure to press it all the way in, then release the collar. Test the installation by giving a firm pull on the tip, to assure that it is inserted all the way and that the locking mechanism is engaged.

Tips may be sterilized by steam autoclave, ethylene oxide gas, or chemical vapor process. Maximum sterilization temperature is 280° Fahrenheit (138° Celsius). Be sure to thoroughly rinse all cleaning agents from the tips before sterilization. This is particularly important when using chemical vapor, because cleaning agents may react with sterilization chemicals and form crystals that can clog the tips.

## TROUBLESHOOTING & REPAIR

Water leakage around the button

*or leaks out tip  
when not using.*

Replace the button assembly #3085. To remove the button, use a paper clip wire to push the retaining pin out of the syringe head, then gently pry the button assembly out of the syringe head. When re-installing the buttons, be sure the springs are properly seated, with the smaller end facing upward. While holding both buttons down, insert the retaining pin through the syringe head.

Alternatively, you may replace the O-rings on the button assembly, using DCI Syringe Repair Kit #3066. After removing the button, slide the E-ring from the stem, and pull the button from the spool.

Momentary spurt of water when  
the air button is pressed

Check first to ensure that the syringe tip is undamaged and fully seated in the Quick-Change Tip adapter. If it is, the O-ring (#2255) under the tip adapter should be replaced. Remove the tip, and use a 5/32-inch hex key to unscrew the adapter from the syringe head.

Use a dental pick or a bent paper clip to remove the small O-ring from the bottom of the bore in the syringe body. Be careful not to nick or scratch the sealing surfaces. The best way to install the replacement is to slip it onto the end of a syringe tip, apply silicone lubricant, then insert it into the bore.

Before reinstalling the adapter and collar assembly, look down into the bore in the syringe body and assure that the alignment pin is in place. With the spring in place in the collar, align the slot in the collar with the pin, then push the collar into the syringe body. Tighten the adapter firmly (30-35 in.-lbs. torque). If you don't have a torque measuring device, hold the hex key by the short end, with the long end in the tip adapter. If you tighten the adapter as tightly as you can while holding the tool this way, you will have approximately the right torque.

ARC EQUIPMENT and SUPPLIES  
your dental dealer  
1411 Broadway  
Santa Monica, CA 90404  
910-394-1551 FAX 310-394-48